



James E. Latham

Northside High School

The project is constructed on a “Greenfield” site immediately north of the existing high school, which became a middle school.

Exterior features include an interior courtyard, multiple brick patterns and a standing seam roof. Inside the facility, students will have a multi-purpose cafetorium and full athletic facilities.

The school was occupied in August 2003.

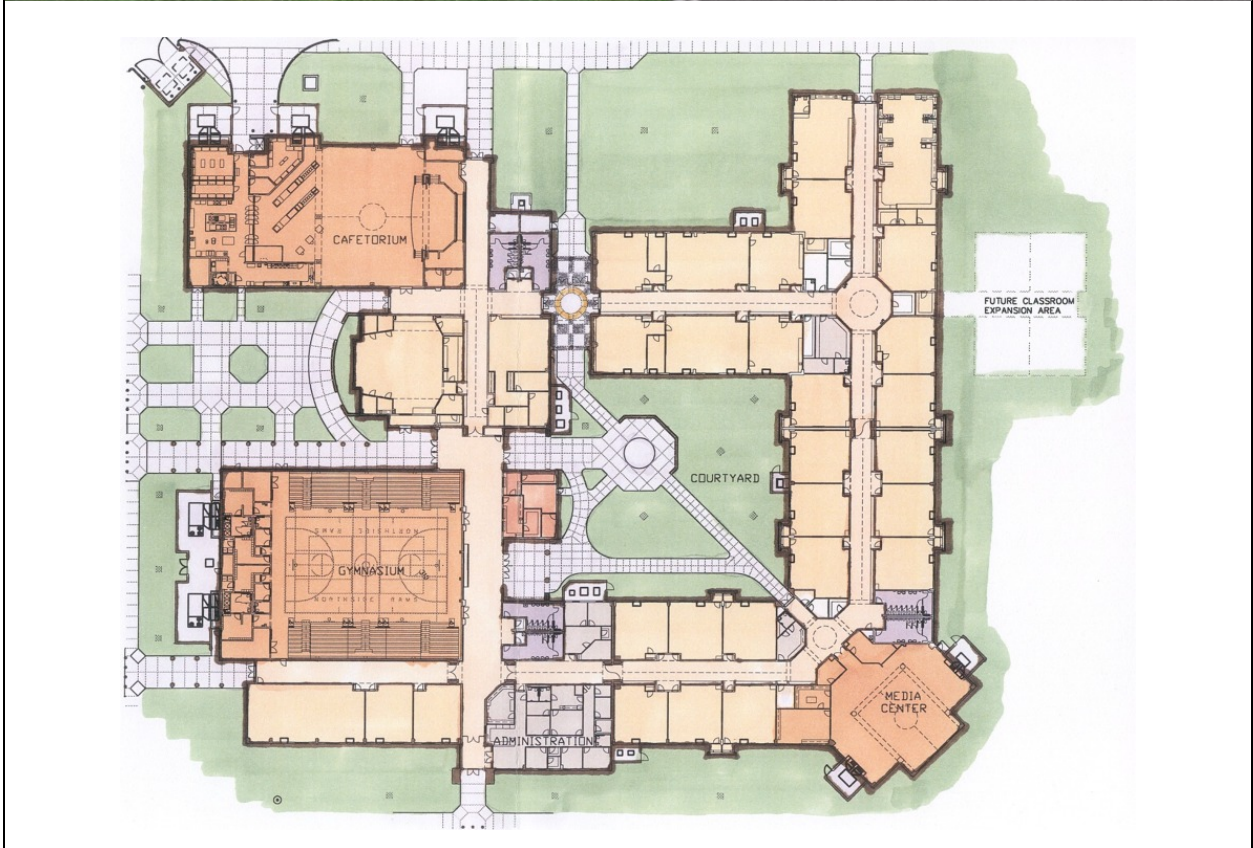

Owner: Tuscaloosa County Board of Education
Architect: Ellis Architects, Inc.
Contracting Method: Construction Management

